

Concertina

Installation Manual



1. tools

- wiremans's pliers
- Side cutter
- Gloves
- Binding wire
- 2 short bars
- Long bar
- Bekaclip pliers
- Forklift or crane



2. installation

Stretch the concertina till the moment that you have reached the indicated deployed length or nominal diameter. To do this, you can use 2 bars to pull on the concertina.

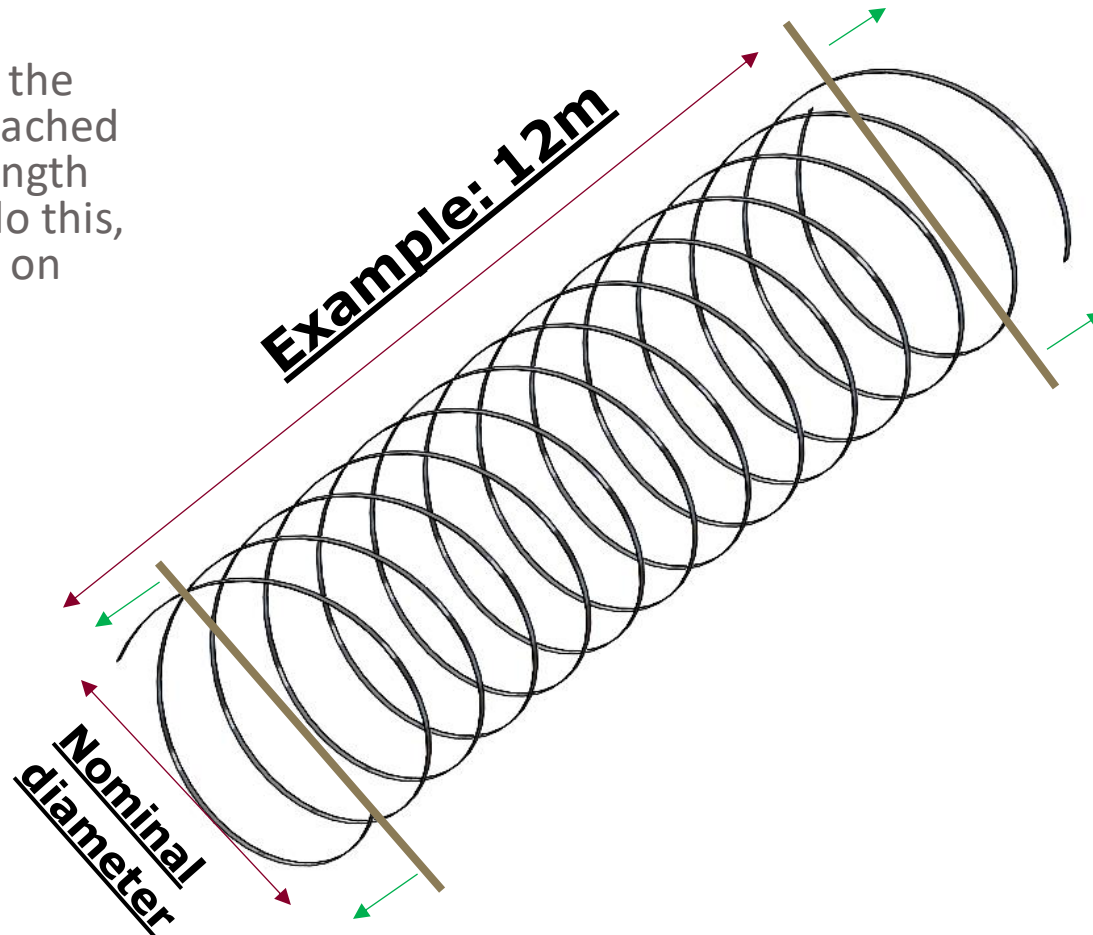

2. installation

Put a long bar through the concertina.

Fix the ends of the concertina with binding wire on the bar

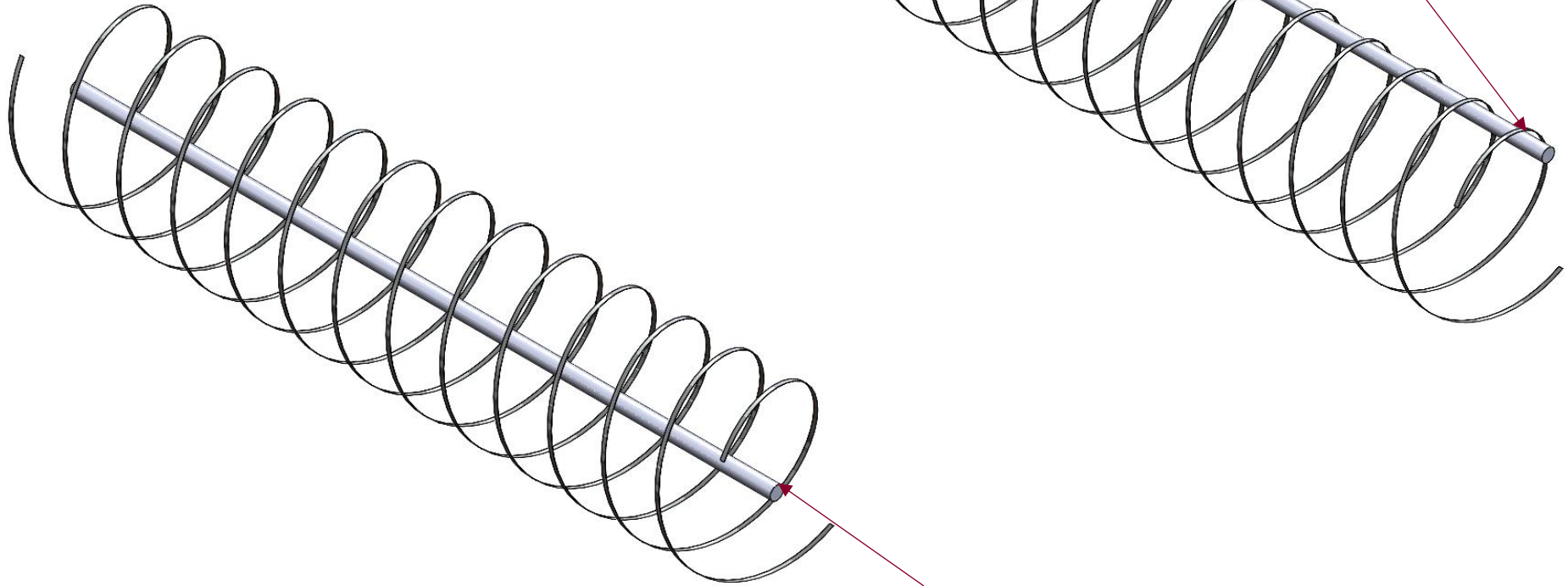

2. installation

Lift the bar with concertina. You can do this manually, with a forklift or a crane.

Once in position, fix the concertina on the wires with stainless steel clips.

Place clips where concertina and wires are touching each other.

Use at least 10 stainless steel clips per running meter of fence.

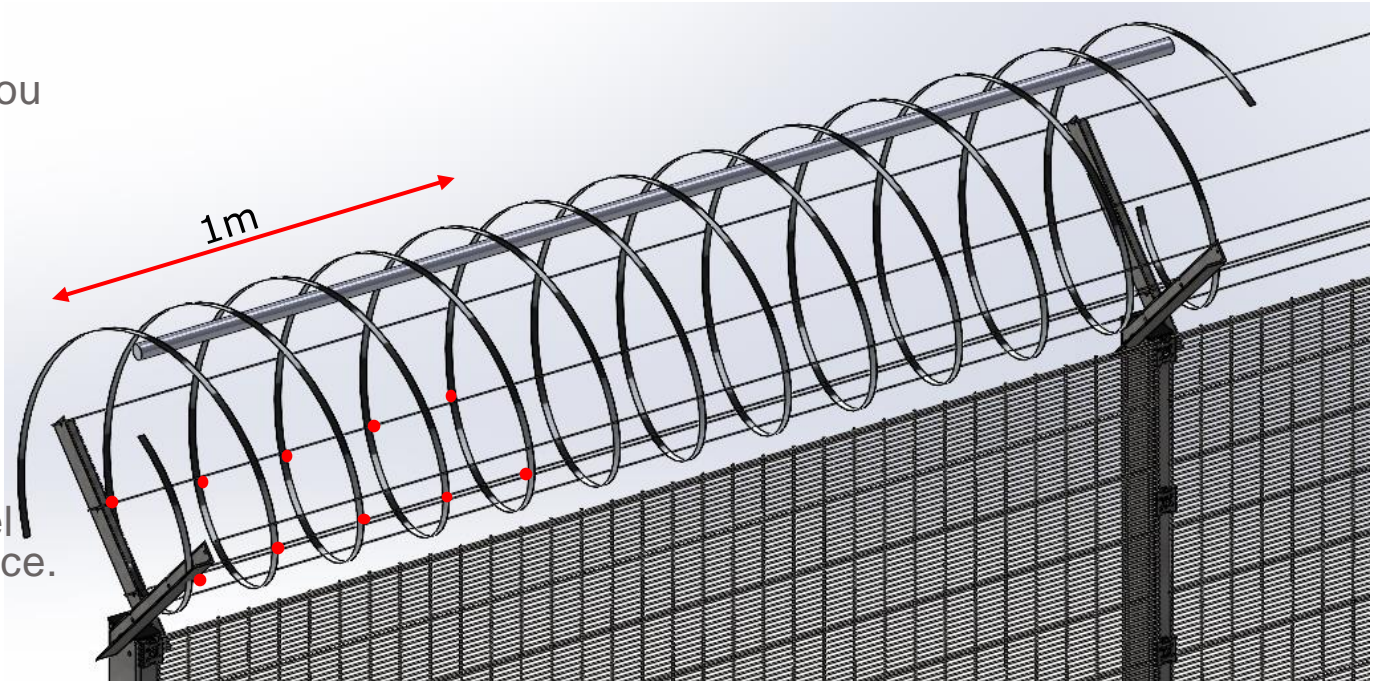

2. installation

Once the concertina is completely fixed on the wires, you can cut the binding wires on the bar.

Remove the bar and start with the next roll.

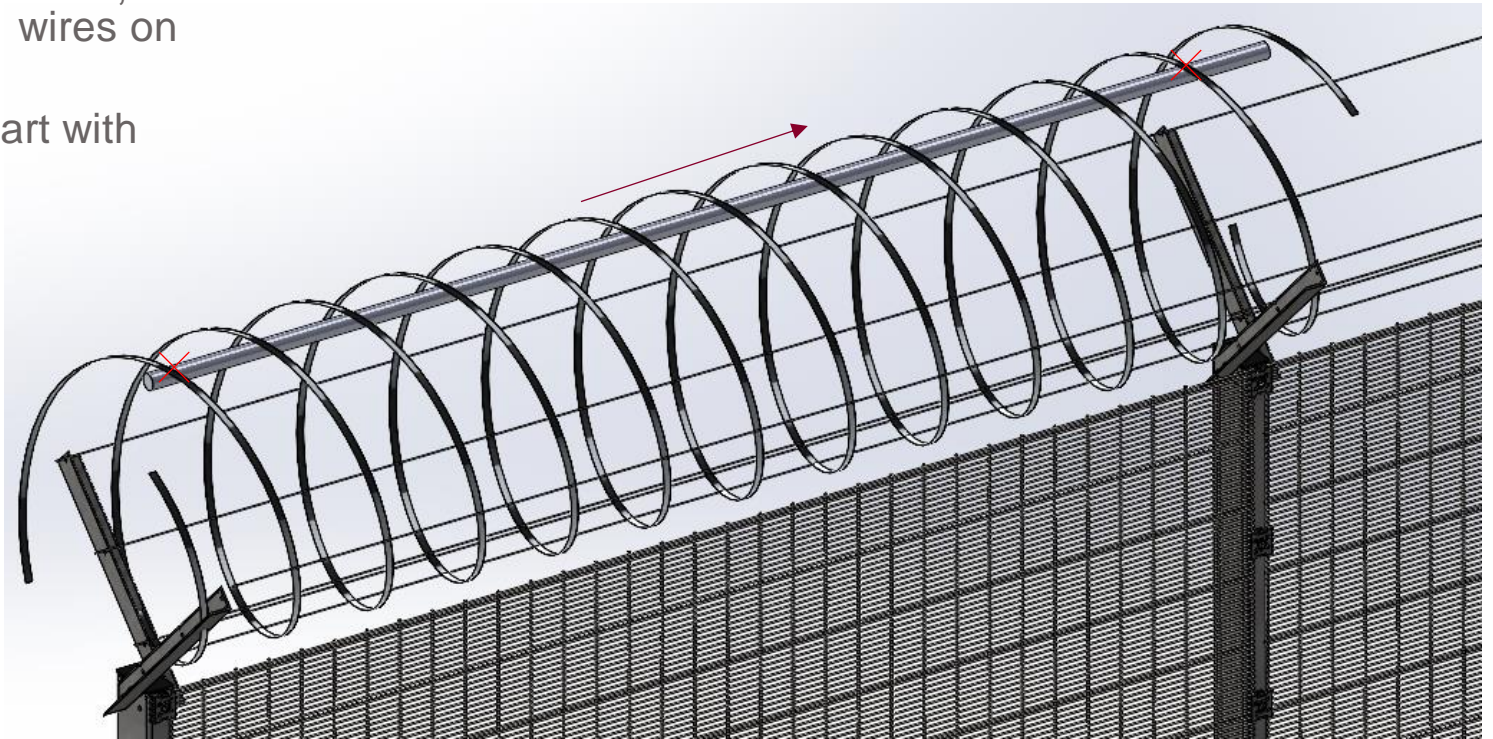

2. installation

Stretch the next roll of concertina.

Put in the bar and fix again with binding wire.

Bring this roll in the correct position and connect the two rolls with at least 3 stainless steel clips.

After this connection you can fix the concertina again to the wires by using 10 clips per running meter of fence.

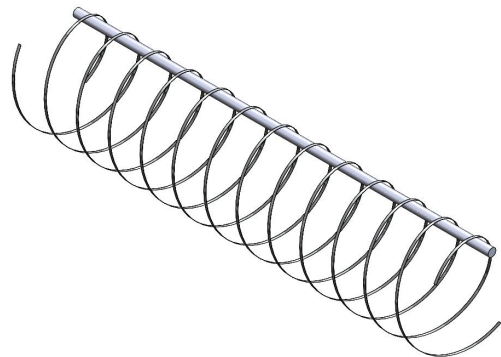
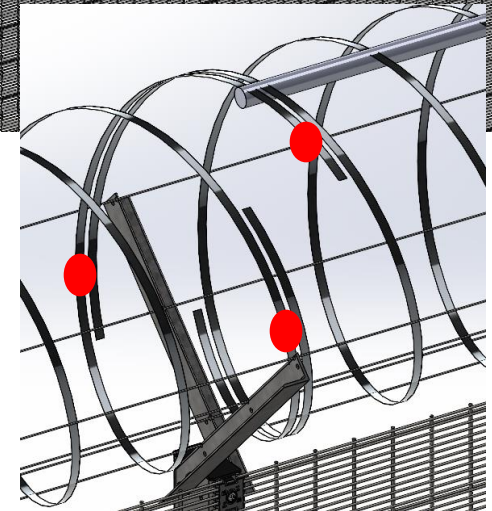

2. installation

Do the same for the rest of the fence where concertina is needed



B BETAFENCE

B **BETAFENCE**
a PRÆSIDIAD brand